

## BPC Male Straight Connector - Nickel Plated Brass Push in Fittings

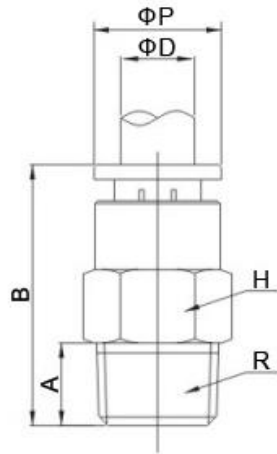

**Material:** Nickel Plated Brass

**Fluid Admitted:** Air, Water, Steam, and other Liquid

**Working Pressure:** 0~2.0MPa | 0~290psi

**Proof Pressure:** 3.0Mpa | 435psi

**Negative Pressure:** -100Kpa | -29.5 In Hg

**Working Temperature:** 20~150°C | -4~302°F

**Applicable Tube:** PU / PA / Teflon Tubing

**Seal, O-ring:** NBR

### Metric / Inch Tubing to R, BSPT Thread Male Straight Connector Nickel Plated Brass Push in Fittings

PART NO.	Tube ΦD	R	A(mm)	B(mm)	ΦP	H(mm)
BPC 04-M5	4	M5	4	19	8	8
BPC 04-01	4	R1/8	7	16	8	10
BPC 04-02	4	R1/4	9	18	8	14
BPC 04-03	4	R3/8	9.5	19	8	17
BPC 06-M5	6	M5	4	25	12	12
BPC 06-01	6	R1/8	7	24	12	12
BPC 06-02	6	R1/4	9	19	12	14
BPC 06-03	6	R3/8	9.5	19	12	17
BPC 06-04	6	R1/2	11	20	12	21
BPC 08-01	8	R1/8	7	27.5	14	14
BPC 08-02	8	R1/4	9	27.5	14	14
BPC 08-03	8	R3/8	9.5	21	14	17
BPC 08-04	8	R1/2	11	21	14	17
BPC 10-01	10	R1/8	7	29.5	16	17
BPC 10-02	10	R1/4	9	29	16	17
BPC 10-03	10	R3/8	9.5	24	16	17
BPC 10-04	10	R1/2	11	23	16	21
BPC 12-01	12	R1/8	7	30	18	19
BPC 12-02	12	R1/4	9	32	18	19
BPC 12-03	12	R3/8	9.5	30	18	19
BPC 12-04	12	R1/2	11	23	18	21
BPC 14-02	14	R1/4	9	36	21	21
BPC 14-03	14	R3/8	9.5	36	21	21
BPC 14-04	14	R1/2	11	35	21	21
BPC 16-02	16	R1/4	9	36	23	24
BPC 16-03	16	R3/8	9.5	37	23	24
BPC 16-04	16	R1/2	11	37	23	24

### Inch Tubing to R, BSPT Thread Male Straight Connector Nickel Plated Brass Push in Fittings

PART NO.	Tube ΦD	R	A(mm)	B(mm)	ΦP(mm)	H(mm)
BPC 5/32-M5	5/32"	M5	4	19	8	8
BPC 5/32-01	5/32"	R1/8	7	16	8	10
BPC 5/32-02	5/32"	R1/4	9	18	8	14
BPS 5/32-03	5/32"	R3/8	9.5	19	8	17
BPC 1/4-M5	1/4"	M5	4	25	12	12
BPC 1/4-01	1/4"	R1/8	7	24	12	12
BPC 1/4-02	1/4"	R1/4	9	19	12	14
BPC 1/4-03	1/4"	R3/8	9.5	19	12	17
BPC 1/4-04	1/4"	R1/2	11	20	12	21
BPC 5/16-01	5/16"	R1/8	7	27.5	14	14
BPC 5/16-02	5/16"	R1/4	9	27.5	14	14
BPC 5/16-03	5/16"	R3/8	9.5	21	14	17
BPC 5/16-04	5/16"	R1/2	11	21	14	17
BPC 3/8-01	3/8"	R1/8	7	29.5	16	17
BPC 3/8-02	3/8"	R1/4	9	29	16	17
BPC 3/8-03	3/8"	R3/8	9.5	24	16	17
BPC 3/8-04	3/8"	R1/2	11	23	16	21
BPC 1/2-01	1/2"	R1/8	7	30	18	19
BPC 1/2-02	1/2"	R1/4	9	32	18	19
BPC 1/2-03	1/2"	R3/8	9.5	30	18	19
BPC 1/2-04	1/2"	R1/2	11	23	18	21

### Inch Tubing to NPT Thread Male Straight Connector Nickel Plated Brass Push in Fittings

PART NO.	Tube ΦD	R	A(mm)	B(mm)	ΦP(mm)	H(mm)
BPC 5/32-U10	5/32"	10-32 UNF	4	19	8	8
BPC 5/32-N01	5/32"	1/8 NPT	7	16	8	10
BPC 5/32-N02	5/32"	1/4 NPT	9	18	8	14
BPS 5/32-N03	5/32"	3/8 NPT	9.5	19	8	17
BPC 1/4-U10	1/4"	10-32 UNF	4	25	12	12
BPC 1/4-N01	1/4"	1/8 NPT	7	24	12	12
BPC 1/4-N02	1/4"	1/4 NPT	9	19	12	14
BPC 1/4-N03	1/4"	3/8 NPT	9.5	19	12	17
BPC 1/4-N04	1/4"	1/2 NPT	11	20	12	21
BPC 5/16-N01	5/16"	1/8 NPT	7	27.5	14	14
BPC 5/16-N02	5/16"	1/4 NPT	9	27.5	14	14
BPC 5/16-N03	5/16"	3/8 NPT	9.5	21	14	17
BPC 5/16-N04	5/16"	1/2 NPT	11	21	14	17
BPC 3/8-N01	3/8"	1/8 NPT	7	29.5	16	17
BPC 3/8-N02	3/8"	1/4 NPT	9	29	16	17
BPC 3/8-N03	3/8"	3/8 NPT	9.5	24	16	17
BPC 3/8-N04	3/8"	1/2 NPT	11	23	16	21
BPC 1/2-N01	1/2"	1/8 NPT	7	30	18	19
BPC 1/2-N02	1/2"	1/4 NPT	9	32	18	19
BPC 1/2-N03	1/2"	3/8 NPT	9.5	30	18	19
BPC 1/2-N04	1/2"	1/2 NPT	11	23	18	21

### Metric Tubing to NPT Thread Male Straight Connector Nickel Plated Brass Push in Fittings

PART NO.	Tube ΦD	R	A(mm)	B(mm)	ΦP	H(mm)
BPC 04-U10	4	10-32 UNF	4	19	8	8
BPC 04-N01	4	1/8 NPT	7	16	8	10
BPC 04-N02	4	1/4 NPT	9	18	8	14
BPC 04-N03	4	3/8 NPT	9.5	19	8	17
BPC 06-U10	6	10-32 UNF	4	25	12	12
BPC 06-N01	6	1/8 NPT	7	24	12	12
BPC 06-N02	6	1/4 NPT	9	19	12	14
BPC 06-N03	6	3/8 NPT	9.5	19	12	17
BPC 06-N04	6	1/2 NPT	11	20	12	21
BPC 08-N01	8	1/8 NPT	7	27.5	14	14
BPC 08-N02	8	1/4 NPT	9	27.5	14	14
BPC 08-N03	8	3/8 NPT	9.5	21	14	17
BPC 08-N04	8	1/2 NPT	11	21	14	17
BPC 10-N01	10	1/8 NPT	7	29.5	16	17
BPC 10-N02	10	1/4 NPT	9	29	16	17
BPC 10-N03	10	3/8 NPT	9.5	24	16	17
BPC 10-N04	10	1/2 NPT	11	23	16	21
BPC 12-N01	12	1/8 NPT	7	30	18	19
BPC 12-N02	12	1/4 NPT	9	32	18	19
BPC 12-N03	12	3/8 NPT	9.5	30	18	19
BPC 12-N04	12	1/2 NPT	11	23	18	21
BPC 14-N02	14	1/4 NPT	9	36	21	21
BPC 14-N03	14	3/8 NPT	9.5	36	21	21
BPC 14-N04	14	1/2 NPT	11	35	21	21
BPC 16-N02	16	1/4 NPT	9	36	23	24
BPC 16-N03	16	3/8 NPT	9.5	37	23	24
BPC 16-N04	16	1/2 NPT	11	37	23	24